

SINGLE DOUBLE SPROCKET

Our Standard A Type Single Double-Sprockets are designed for use with two single strand chains. The sprockets are made of carbon steel (SAE 1035) and hardened teeth. The maximum bore diameters shown below are based on general operating conditions using standard keys and key tapping procedure. Actual bore diameter should be determined using common machine design considerations. Key surface pressure should be checked on the same basis as above.

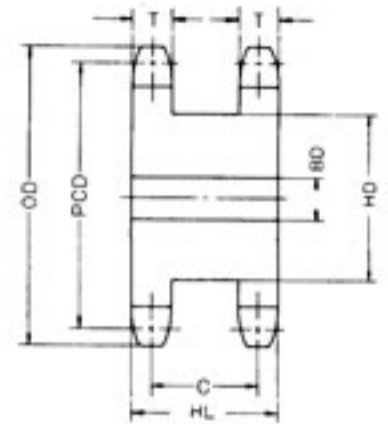
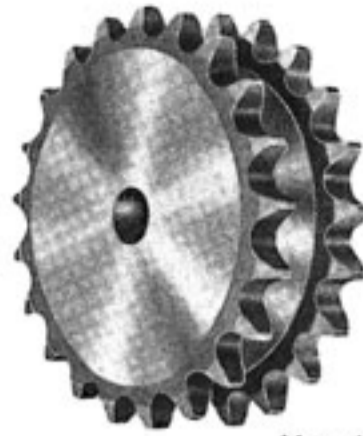

Material: SAE 1040

Dimension: inch & mm

	No. of Teeth	Outside Dia (OD)		Pitch Dia (P.C.D)		C		Bore (BD)				Hub				Approx. Weight (kg)								
		inch	mm	inch	mm	inch	mm	Stock		Max.		HD		HL										
								inch	mm	inch	mm	inch	mm	inch	mm									
40SD	12	2.17	55	1.932	49.07	1.094	27.8	0.43	11	0.67	17	1.339	34	1.378	35	0.33								
	13	2.33	59	2.089	53.07			0.55	14	0.79	20	1.496	38				0.40							
	14	2.49	63	2.247	57.07			0.55	14	0.94	24	1.654	42					0.49						
	15	2.65	67	2.405	61.08			0.55	14	0.98	25	1.811	46						0.57					
	16	2.81	71	2.563	65.10			0.55	14	1.10	28	1.969	50							0.66				
	17	2.98	76	2.721	69.12			0.55	14	1.26	32	2.126	54								0.76			
	18	3.14	80	2.879	73.14			0.55	14	1.38	35	2.323	59									0.89		
	19	3.30	84	3.038	77.16			0.55	14	1.46	37	2.480	63										1.00	
	20	3.46	88	3.196	81.18			0.59	15	1.57	40	2.638	67											1.14
	21	3.62	92	3.355	85.21			0.59	15	1.69	43	2.795	71											
50SD	12	2.72	69	2.415	61.34	1.232	31.3	0.59	15	0.94	24	1.693	43	1.575	40	0.63								
	13	2.91	74	2.612	66.34			0.59	15	0.98	25	1.890	48				0.75							
	14	3.11	79	2.809	71.34			0.59	15	1.18	30	2.087	53					0.90						
	15	3.31	84	3.006	76.35			0.59	15	1.38	35	2.283	58						1.04					
	16	3.50	89	3.204	81.37			0.59	15	1.46	37	2.480	63							1.22				
	17	3.70	94	3.401	86.39			0.59	15	1.65	42	2.677	68								1.41			
	18	3.94	100	3.599	91.42			0.59	15	1.73	44	2.874	73									1.61		
	19	4.13	105	3.797	96.45			0.59	15	1.81	46	3.110	79										1.80	
	20	4.33	110	3.995	101.48			0.59	15	1.97	50	3.307	84											1.95
	21	4.53	115	4.193	106.51			0.59	15	2.13	54	3.504	89											
60SD	12	3.25	83	2.898	73.60	1.508	38.3	0.59	15	1.10	28	2.008	51	1.969	50	1.14								
	13	3.49	89	3.134	79.60			0.59	15	1.38	35	2.244	57				1.39							
	14	3.74	95	3.371	85.61			0.67	17	1.46	37	2.520	64					1.63						
	15	3.98	101	3.607	91.62			0.67	17	1.69	43	2.756	70						1.93					
	16	4.22	107	3.844	97.65			0.67	17	1.81	46	2.992	76							2.20				
	17	4.46	113	4.082	103.67			0.67	17	1.97	50	3.228	82								2.56			
	18	4.70	119	4.319	109.71			0.67	17	2.09	53	3.465	88									2.90		
	19	4.95	126	4.557	115.74			0.67	17	2.17	55	3.701	94										3.26	
	20	5.19	132	4.794	121.78			0.67	17	2.28	58	3.937	100											3.70
	21	5.43	138	5.032	127.82			0.67	17	2.48	63	4.213	107											
80SD	12	4.33	110	3.864	98.14	1.787	45.4	0.83	21	1.65	42	2.716	69	2.362	60	2.52								
	13	4.66	118	4.178	106.14			0.83	21	1.81	46	3.031	77				3.04							
	14	4.98	127	4.494	114.15			0.83	21	1.97	50	3.346	85					3.60						
	15	5.31	135	4.810	122.17			0.83	21	2.17	55	3.661	93						4.16					
	16	5.63	143	5.126	130.20			0.83	21	2.28	58	4.016	102							4.89				
	17	5.95	151	5.442	148.23			0.83	21	2.56	65	4.331	110								5.61			
	18	6.27	159	5.759	156.27			0.83	21	2.68	68	4.646	118									6.36		
	19	6.59	167	6.076	164.32			0.87	22	2.95	75	4.961	126										7.13	
	20	6.91	176	6.393	162.37			0.87	22	3.23	82	5.276	134											8.03
	21	7.24	184	6.710	170.42			0.87	22	3.54	90	5.591	142											
100SD	12	5.42	138	4.830	122.67	2.063	52.4	0.87	22	1.97	50	3.386	86	2.756	70	4.68								
	13	5.82	148	5.223	132.67			0.87	22	2.05	52	3.780	96				5.10							
	14	6.23	158	5.618	142.68			0.87	22	2.44	62	4.213	107					6.65						
	15	6.63	168	6.012	152.71			0.87	22	2.68	68	4.606	117						7.83					
	16	7.03	179	6.407	162.74			0.87	22	2.95	75	5.000	127							9.00				
	17	7.44	189	6.803	172.79			0.87	22	3.35	85	5.000	127								10.30			
	18	7.84	199	7.199	182.84			0.87	22	3.74	95	5.827	148									11.80		
	19	8.24	209	7.594	192.90			1.02	26	3.94	100	6.220	158										13.20	
	20	8.64	220	7.990	202.96			1.02	26	4.33	110	6.614	168											14.70
	21	9.04	230	8.387	213.03			1.02	26	4.72	120	6.693	170											

• Sprockets other than those shown above are manufactured on request.
 • Bore, Keyways and Setscrews will be machined upon request.