

Product Data Series M2500

M2543 Tight Radius 1"



HabasitLINK®
Engineering Guidelines
Edition Q104 - 63

Description

- For radius and straight conveying, ideal for applications with limited space (collapse factor 1.6)
- 35% open area; 57% open contact area; largest opening 7.5x10 mm (0.3"x0.4")
- Excellent for cooling and draining
- Easy to clean
- Food approved materials see pages 9-11
- Rod diameter 5 mm (0.2")
- Suitable for universal 1" "Open window" and split sprockets

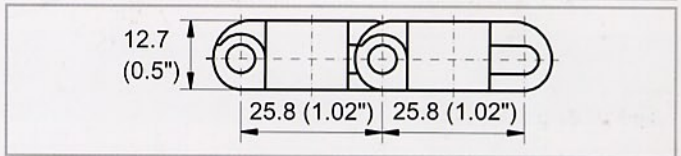
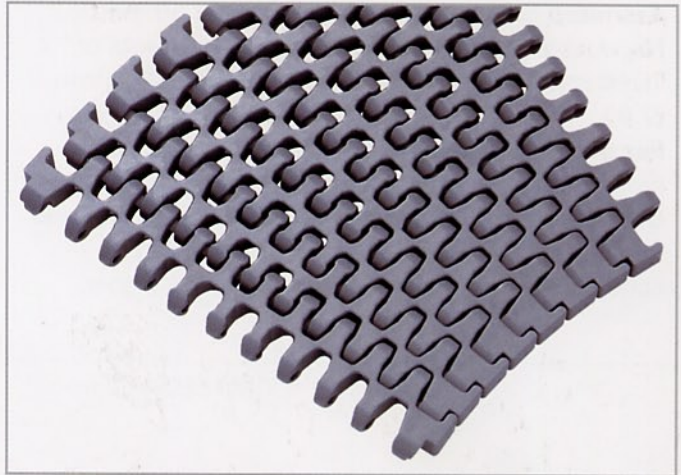

Belt data

Belt material			Polypropylene		Polyacetal
Standard rod material			POM	PA	PA
Nominal tensile strength [F _N] For b ₀ > 450 mm (18") higher values admissible. Refer to LINK-SeleCalc	straight run	N/m lb/ft	14'000 959	14'000 959	20'000 1'370
	in curve	N lb	800 180	800 180	1'200 270
Temperature range		°C	-40 – 90	-40 – 105	-40 – 90
		°F	-40 – 195	-40 – 220	-40 – 195
Belt weight [m _B]		kg/m ² lb/sqft	5.5 1.13	5.5 1.13	7.6 1.56
Coefficient of friction belt to support [μ _s]	• UHMW PE		0.13	0.13	0.10
	• HDPE		0.11	0.11	0.08
	• PA6, PA66		0.30	0.30	0.20
	• Lubricated PA		0.13	0.13	0.11
	• Steel		0.25	0.25	0.14
	• Glass		0.19	0.19	0.15
Coefficient of friction belt to goods [μ _F]	• Steel		0.32	0.32	0.20
	• Plastic (PET)		0.17	0.17	0.18
	• Cardboard		0.22	0.22	0.20
			0.22	0.22	0.20

Standard range of belt widths and collapse factor Q (R_{min} = Q · b₀)

mm	250	300	350	400	450	500	550	600	650	700	750	800	850	900	950
inch (nom.)	10	12	14	16	18	20	22	24	26	28	30	32	34	36	38
Coll.fact. Q	1.43	1.47	1.50	1.52	1.54	1.55	1.56	1.57	1.58	1.58	1.59	1.59	1.60	1.60	1.61
mm	1000	1050	1100	1150	1200	Belt widths larger 1200 mm (48") not recommended; please take contact with Habasit									
inch (nom.)	40	42	44	46	48										
Coll.fact. Q	1.61	1.61	1.62	1.62	1.62										